



COMUNE DI MONTERIGGIONI

PIANO ATTUATIVO

relativo alla progettazione dell'Area di Trasformazione Urbanistica TU 20
(art.31delle NTA di RU) in Loc.San Martino, Comune di Monteriggioni (SI)

Progettazione e realizzazione della strada a senso unico di circonvallazione
delle scuole con collegamento a via delle Nazioni Unite.

Proprietà:



MASSINI & GORI S.r.l.
Via Fratelli Alinari,1 - Monteverchi (AR) tel.055 910 2750 info@massinigorit.it

Progettisti:



ARCH. FIAMMA CATALDO & ARCH. ALBERTO PIERALLINI
Piazza Guido Chigi Saracini, 12 - Siena tel.0577 43165 f.cataldo@studio_12.it a.pierallini@studio_12.it

Progettisti:

ING. FABRIZIO BACCI
Via Aligi Barducci, 26 - San Giovanni Valdarno (AR) tel. 055 9123752 fabrizio.bacci@hotmail.it

Contenuto: SEZIONI STRADALI		Tavola: S03
Data: Luglio 2022	Scala: 1:200	

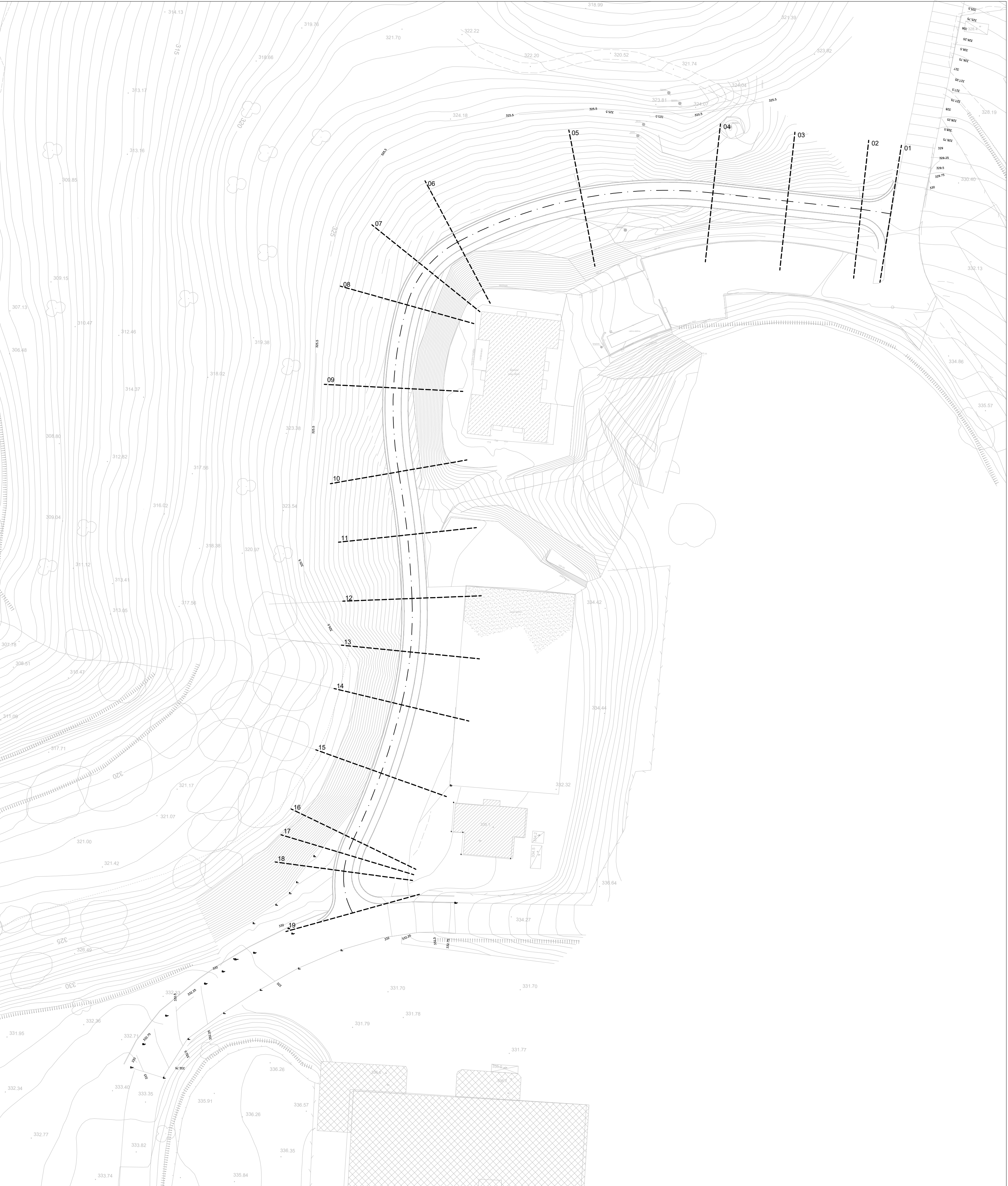

PLANIMETRIA SEZIONI STRADALI scala 1 : 500

SEZ. 1

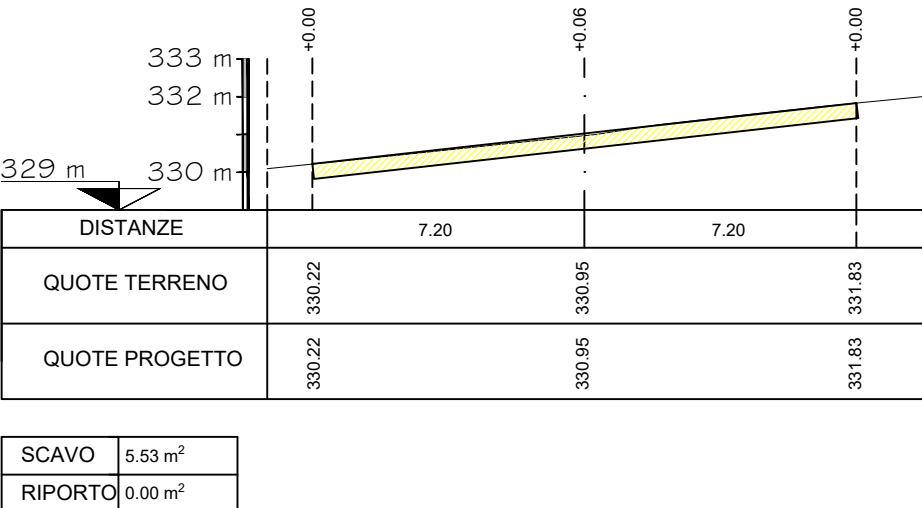

SEZ. 6

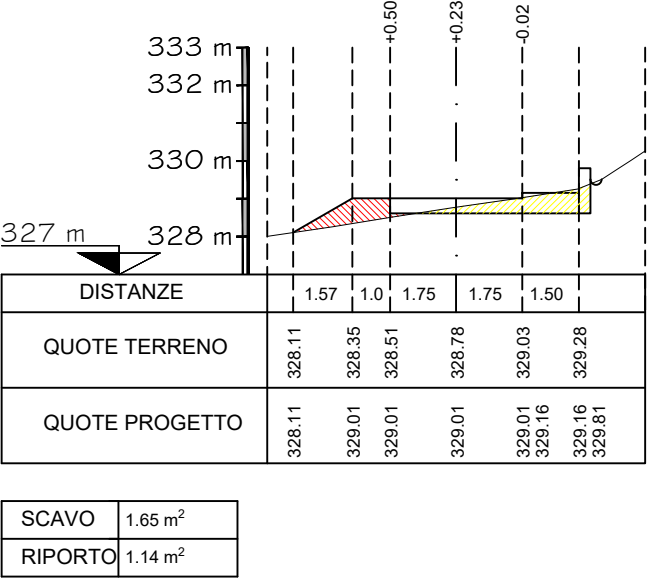

SEZ. 11

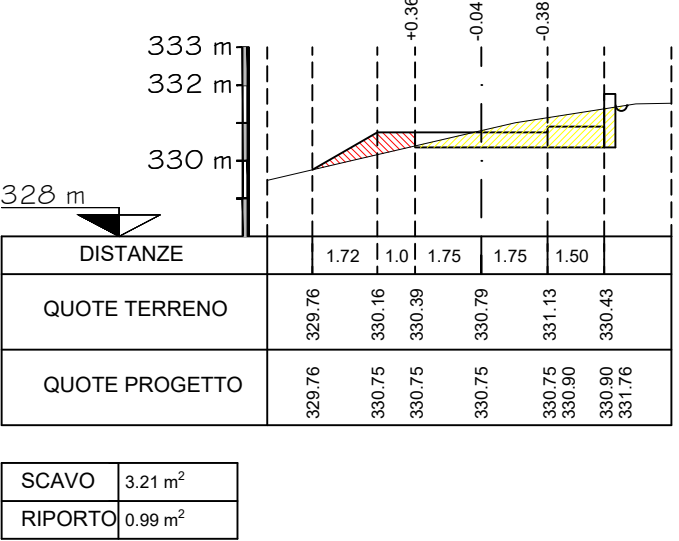

SEZ. 16

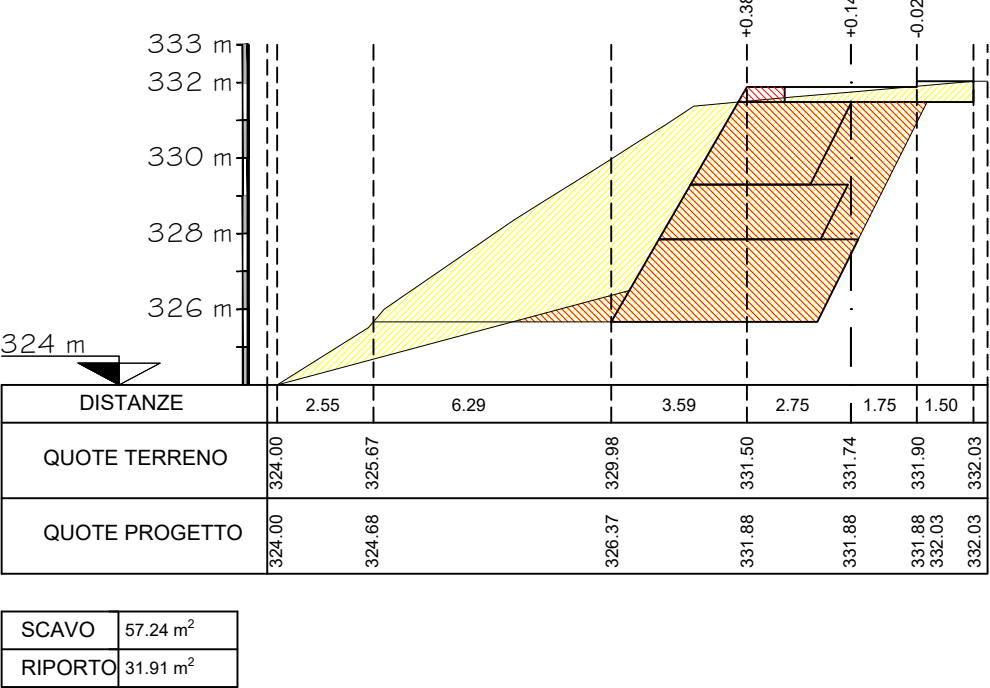

SEZ. 2

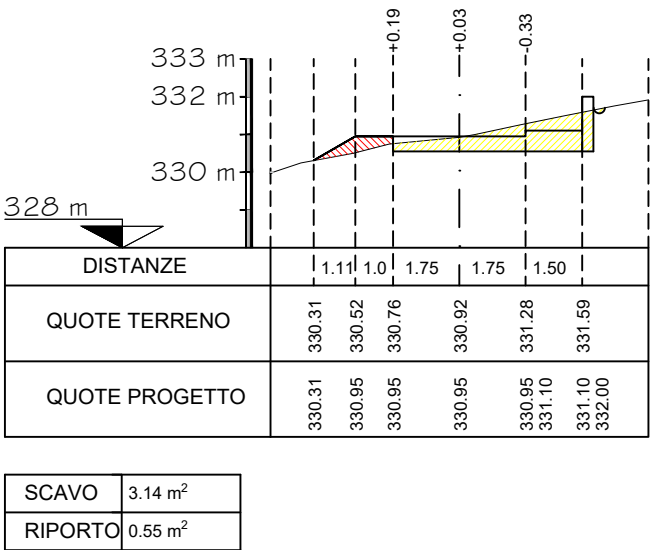

SEZ. 7

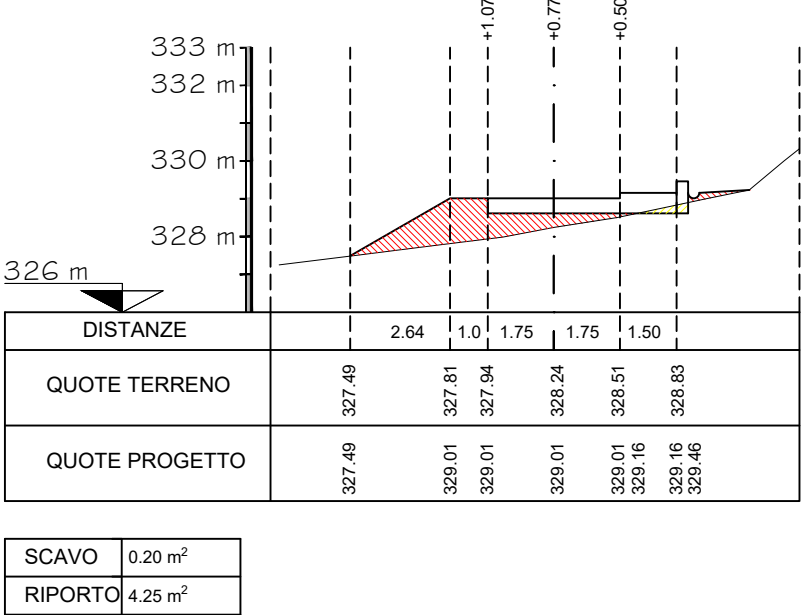

SEZ. 12

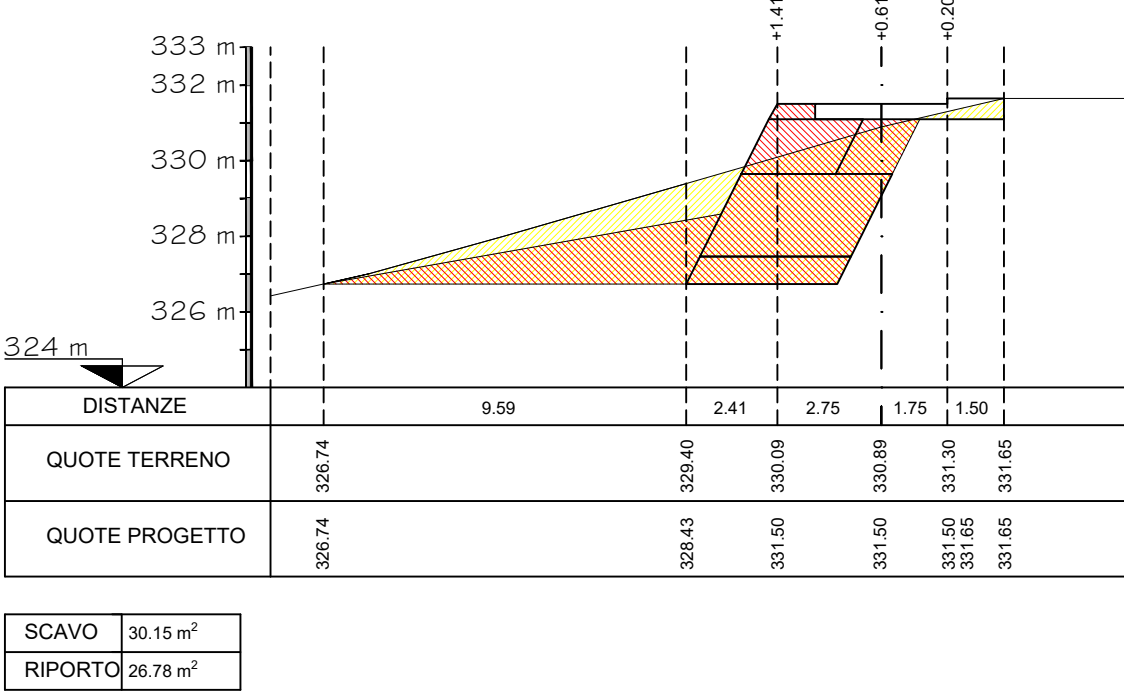

SEZ. 17

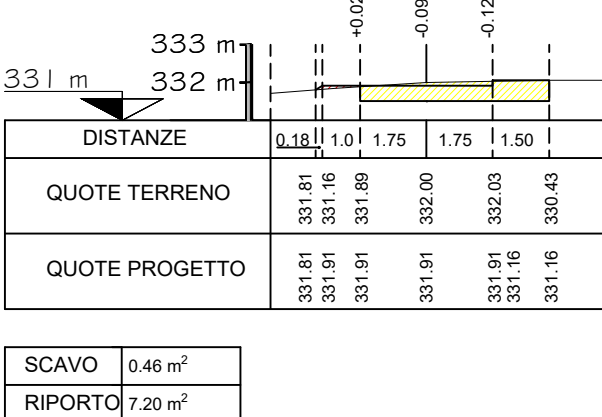

SEZ. 3

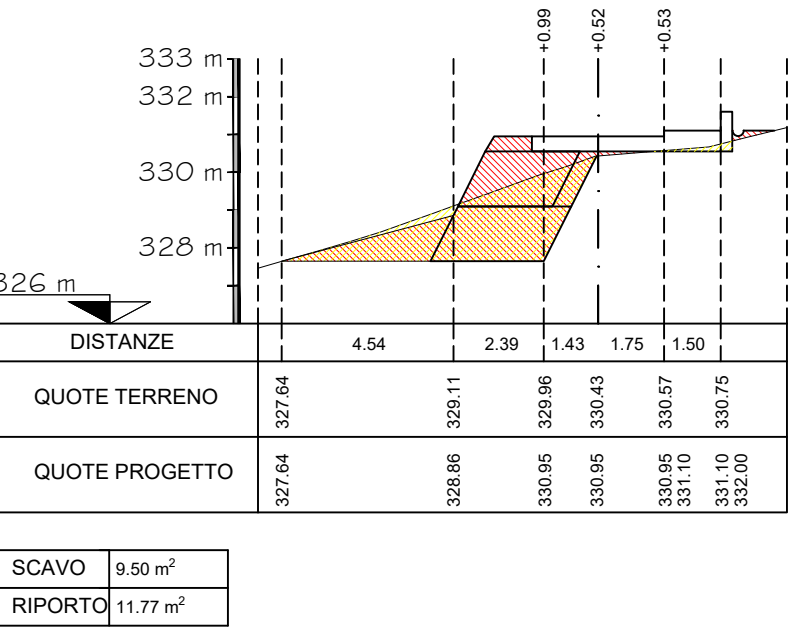

SEZ. 8

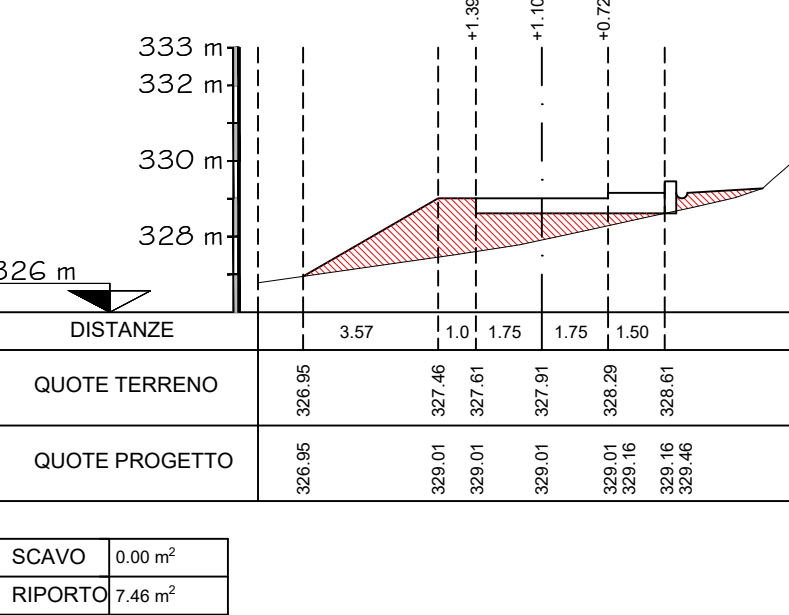

SEZ. 13

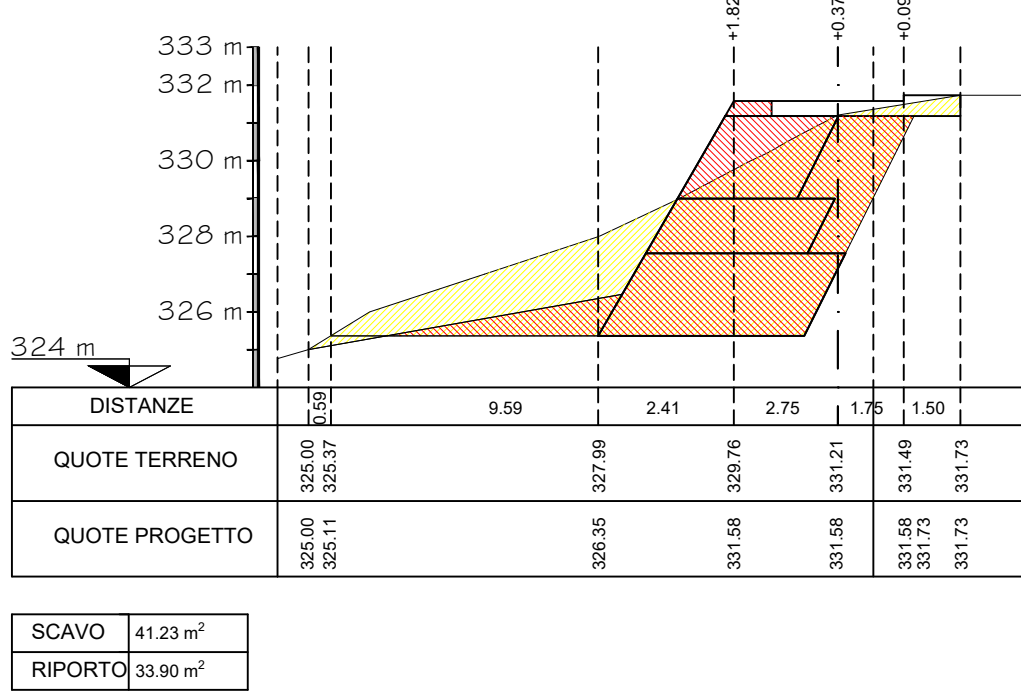

SEZ. 18

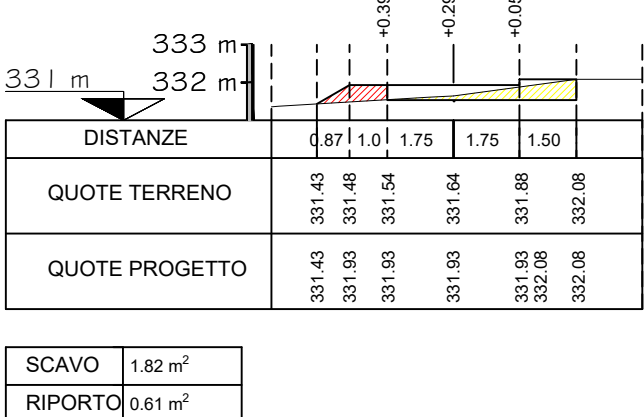

SEZ. 4

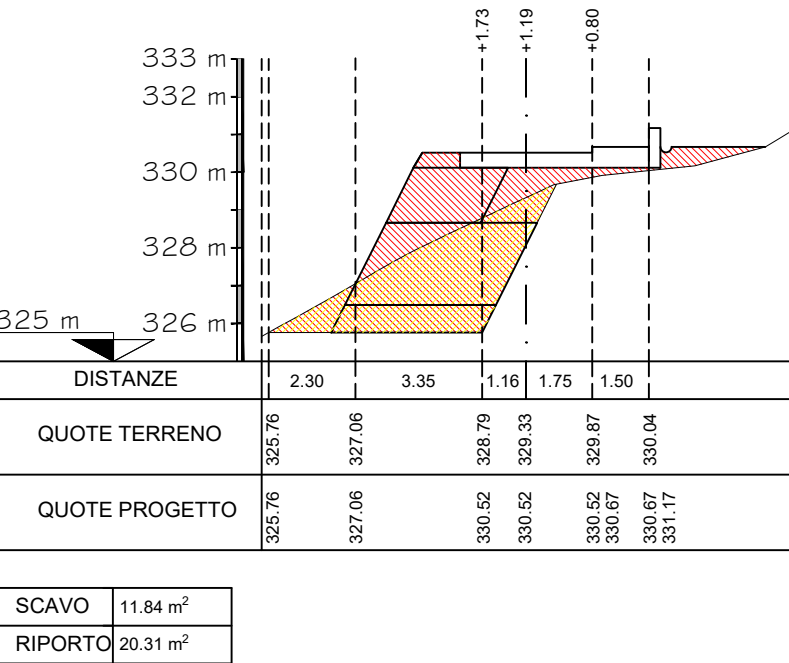

SEZ. 9

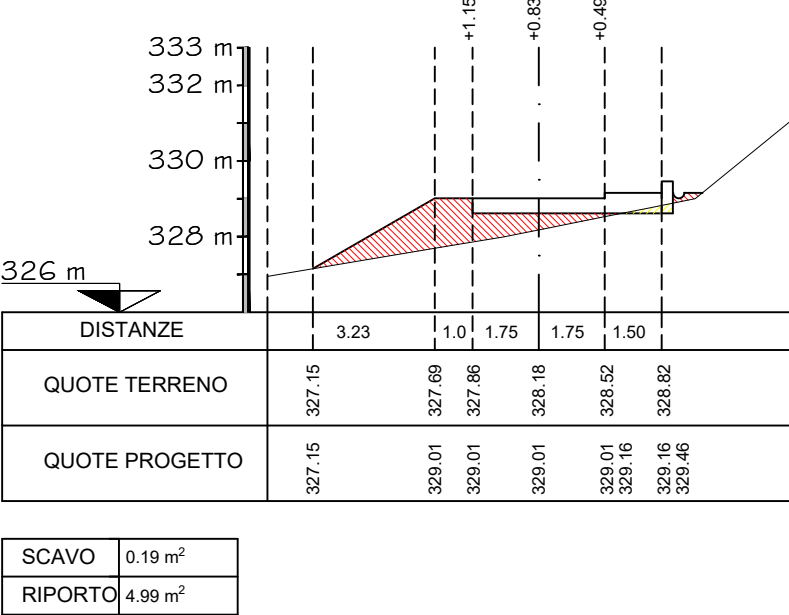

SEZ. 14

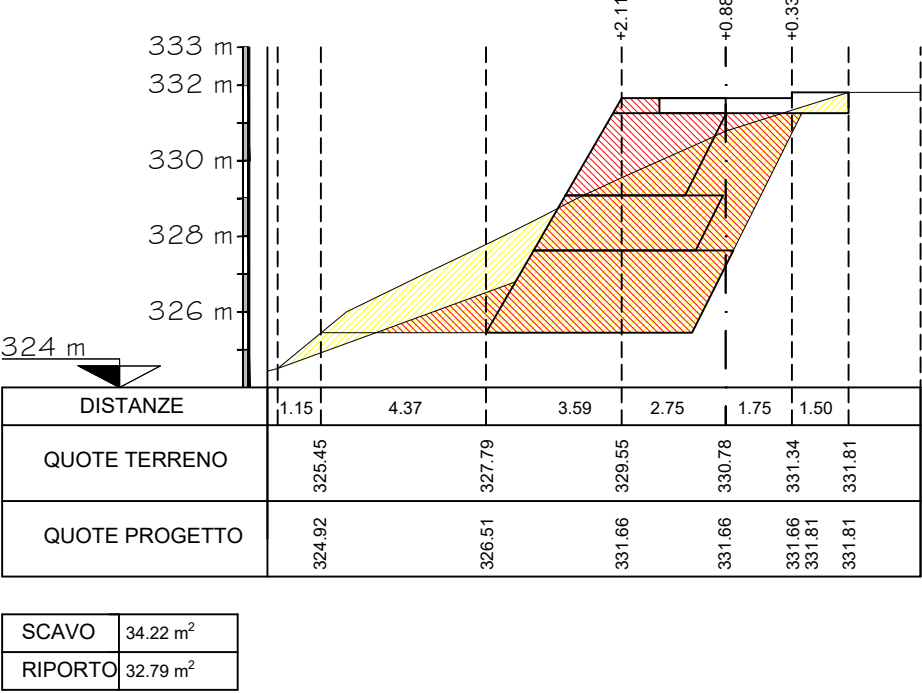

SEZ. 19

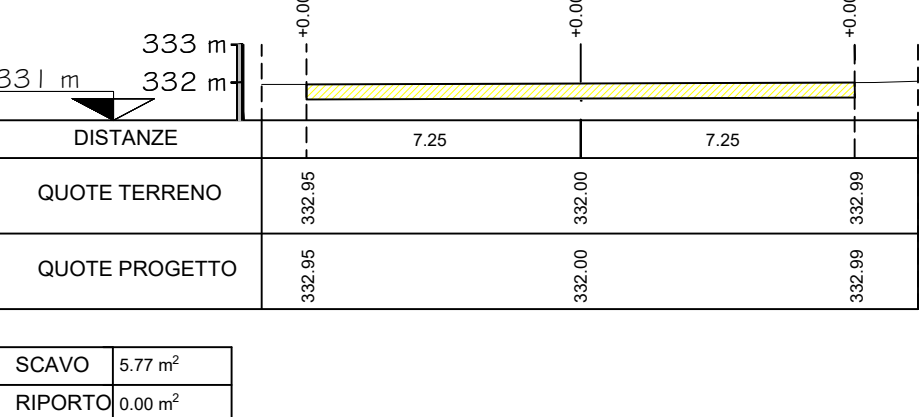

SEZ. 5

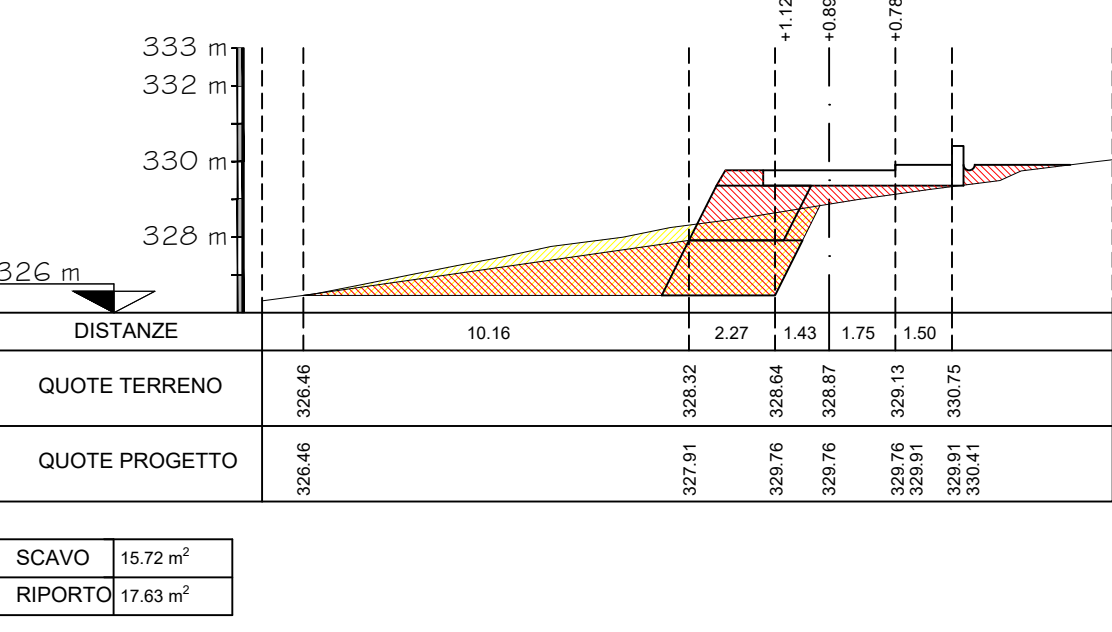

SEZ. 10

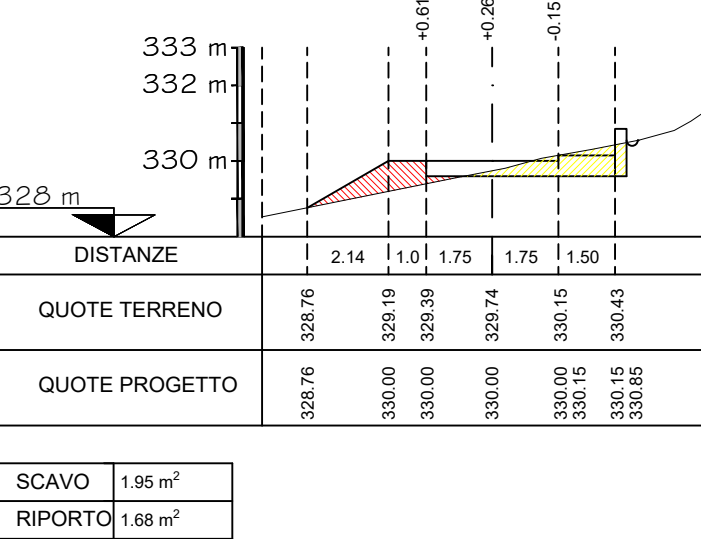

SEZ. 15

